

ASIAN STANDARD LINEAR BUSHING(LM)

## LM CLOSED LINEAR BUSHING

### ● Drawing

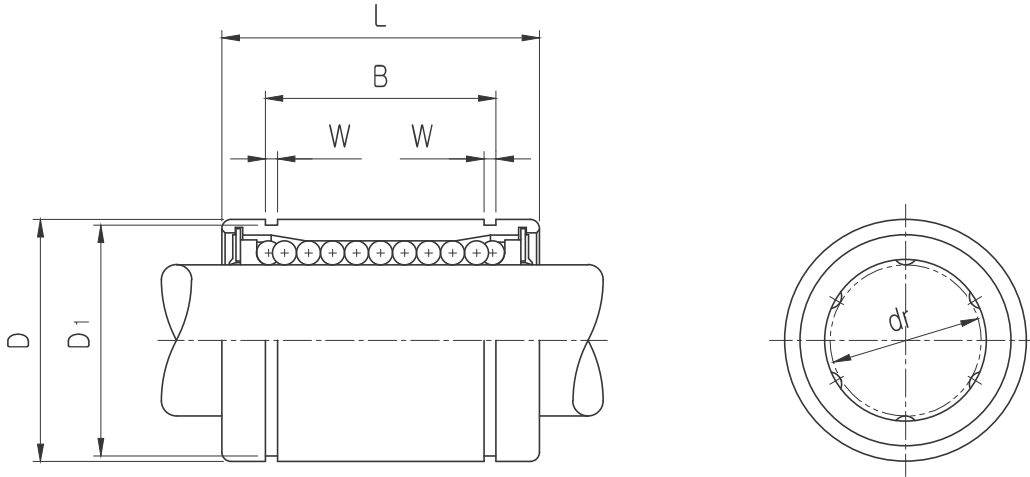

### ● Part Number Notation

**LM 20 UU - A N S**



- SAMICK Linear Bushing
- Nominal Shaft Diameter
- Seal

|       |                |
|-------|----------------|
| Blank | No Seal        |
| UU    | Both Side Seal |
| U     | One Side Seal  |

- Retainer (material)

|       |                                     |
|-------|-------------------------------------|
| Blank | Resin Retainer(Standard)            |
| A     | Steel Retainer(High temperature) *1 |

- Outer-sleeves (by corrosion resistance)

|       |                            |
|-------|----------------------------|
| Blank | Standard(SUJ2)             |
| N     | Electroless nickel plating |
| R     | Raydent treatment          |

- Ball type (material)

|       |  |
|-------|--|
| Blank | High carbon bearing steel ball(Standard) |
| S     | Stainless steel ball                     |

\*1 Steel retainer applicable from LM6 to LM25 only  
(LM8S applicable with resin retainer only)



## LM CLOSED LINEAR BUSHING

| PART NUMBER |                     | WORKING BORE DIAMETER |               | D   |               | L   |               | B     |               | W    | D <sub>1</sub> | BASIC LOAD RATING(N) <sup>*4</sup> |                          | NO. OF BALL ROW | WEIGHT (gf) <sup>*2</sup> |
|-------------|---------------------|-----------------------|---------------|-----|---------------|-----|---------------|-------|---------------|------|----------------|------------------------------------|--------------------------|-----------------|---------------------------|
| Resin       | Steel <sup>*5</sup> | dr. (mm)              | CLEAR NCE(mm) | mm  | CLEAR NCE(mm) | mm  | CLEAR NCE(mm) | mm    | CLEAR NCE(mm) |      |                | DYNAMIC (C) <sup>*1</sup>          | STATIC (C <sub>0</sub> ) |                 |                           |
| LM5UU       |                     | 5                     | 0<br>-0.008   | 10  | 0<br>-0.008   | 15  | 0<br>-0.12    | 10.2  |               | 1.1  | 9.6            | 167                                | 206                      | 4               | 4                         |
| LM6UU       | LM6-A               | 6                     |               | 12  |               | 19  |               | 13.5  |               | 1.1  | 11.5           | 200                                | 260                      | 4               | 8                         |
| LM8SUU      |                     | 8                     |               | 15  | 0<br>-0.011   | 17  |               | 11.5  |               | 1.1  | 14.3           | 170                                | 220                      | 4               | 11                        |
| LM8UU       | LM8-A               | 8                     |               | 15  |               | 24  |               | 17.5  |               | 1.1  | 14.3           | 260                                | 400                      | 4               | 16                        |
| LM10UU      | LM10-A              | 10                    | 0<br>-0.009   | 19  |               | 29  | 0<br>-0.2     | 22.0  | 0<br>-0.2     | 1.3  | 18             | 370                                | 540                      | 4               | 30                        |
| LM12UU      | LM12-A              | 12                    |               | 21  | 0<br>-0.013   | 30  |               | 23.0  |               | 1.3  | 20             | 410                                | 590                      | 4               | 31.5                      |
| LM13UU      | LM13-A              | 13                    |               | 23  |               | 32  |               | 23.0  |               | 1.3  | 22             | 500                                | 770                      | 4               | 43                        |
| LM16UU      | LM16-A              | 16                    |               | 28  |               | 37  |               | 26.5  |               | 1.6  | 27             | 770                                | 1170                     | 5               | 69                        |
| LM20UU      | LM20-A              | 20                    |               | 32  |               | 42  |               | 30.5  |               | 1.6  | 30.5           | 860                                | 1370                     | 5               | 87                        |
| LM25UU      | LM25-A              | 25                    | 0<br>-0.010   | 40  | 0<br>-0.016   | 59  |               | 41.0  |               | 1.85 | 38             | 980                                | 1560                     | 6               | 220                       |
| LM30UU      |                     | 30                    |               | 45  |               | 64  |               | 44.5  |               | 1.85 | 43             | 1560                               | 2740                     | 6               | 250                       |
| LM35UU      |                     | 35                    |               | 52  |               | 70  | 0<br>-0.3     | 49.5  | 0<br>-0.3     | 2.1  | 49             | 1660                               | 3130                     | 6               | 390                       |
| LM40UU      |                     | 40                    | 0<br>-0.012   | 60  | 0<br>-0.019   | 80  |               | 60.5  |               | 2.1  | 57             | 2150                               | 4010                     | 6               | 585                       |
| LM50UU      |                     | 50                    |               | 80  |               | 100 |               | 74.0  |               | 2.6  | 76.5           | 3820                               | 7930                     | 6               | 1580                      |
| LM60UU      |                     | 60                    | 0<br>-0.015   | 90  | 0<br>-0.022   | 110 |               | 85.0  |               | 3.15 | 86.5           | 4700                               | 9990                     | 6               | 2000                      |
| LM80UU      |                     | 80                    |               | 120 |               | 140 | 0<br>-0.4     | 105.5 | 0<br>-0.4     | 4.15 | 116            | 10130                              | 12000                    | 6               | 4100                      |

- ★1 Dynamic load rating is based on the nominal life of 50km  
In case of 100km, C on the table need to be divided by 1.26  
Ex) 50km basic dynamic load rating(C) of LM12 = 410N  
100km basic dynamic load rating(C<sub>100</sub>) of LM12 = 410/1.26 = 325.40N
- ★2 Based on the weight of resin retainer
- ★3 Main unit : mm
- ★4 1N ≅ 0.102kgf
- ★5 Steel retainer applicable from LM6 to LM25 only (LM8S resin retainer only)

